



DIY CARPET & UPHOLSTERY Cleaning Guide



LIVE **CLEAN** *love* **BRITE**

Why should I deep clean?

In every household, dirt, allergens, bacteria, stains and pet hair can build up in your carpets, rugs and upholstered furniture over time. A periodic deep clean not only revitalises the appearance of your carpets and furniture, it can also help to maintain a healthy home environment. Britex deep cleaning machines use the power of hot water extraction to reach deep within your carpet and upholstery fibres to remove stains and other nasties that normal vacuuming simply won't reach.

Why DIY with Britex?



Save
Money



Quick
Dry



Easy
to Use



Biodegradable
Surfactants



Family
Safe



Australian
Owned

I'm ready to clean! What do I need to hire a machine?

To hire a Britex machine, you'll need to visit the service counter at your hire outlet and present:

- Your mobile phone number.
- 2 forms of identification. ID may include your Australian driver's license and a 2nd document that validates your address (e.g. a utility bill, bank statement or lease).

Q&A's

How often should I deep clean?

We recommend deep cleaning every 6 to 12 months, particularly if you or a family member have allergies.

How long can I hire a Britex machine for?

Either 24 or 48 hours.

How long will it take for my carpet and rugs to dry?

The commercial grade suction of the Britex machine means your carpet usually dries within 4 hours. To assist with drying time, we recommend putting your heater on in cold weather and opening up windows and doors in warmer weather. If you need to walk on your damp carpet, please put a clean towel down on the areas you need to step on.

Should I vacuum my carpet prior to deep cleaning?

Yes! For the best possible cleaning results you should vacuum your carpets first to remove large pieces of debris.

How do I empty the clean water tank B?

Press the tap button at back of machine

How do I disconnect the thin solution hose from the machine?

With your finger & thumb push the brass sleeve of the hose towards the machine.

Do I need to have both pump & vac buttons on at the same time?

Yes, however you can just have the vac button on if you need to vacuum up excess water.

Your shopping list:

For cleaning carpet and rugs:



The Britex machine
& carpet wand.



Double strength Britex
Carpet Cleaning Solution

1L cleans approximately
120m² or 6 average sized
rooms of carpet

500ml cleans approximately
60m² or 3 average sized
rooms of carpet

Do you need to clean carpeted stairs?

Hire the Britex Upholstery wand to
easily clean carpeted stairs.



For cleaning upholstered furniture:



The Britex
machine



Upholstery
wand



Britex Upholstery
cleaning solution

Britex Upholstery Cleaner is specially formulated to remove stains and soiling from fabric upholstery, while still being gentle on delicate upholstery fibres.

You can also use the Britex upholstery wand to deep clean:

- Car interiors and children's car seats.
- Boat upholstery.
- Caravan upholstery and carpet.

How to set-up the Britex machine

- 1 Remove the dome lid on Tank A and take out the thin solution hose and vacuum hose. Take the small end of the thin solution hose and connect it to the brass connection point under the vac & pump buttons on the front of the Britex machine (1a).



TIP: The brass connector on the machine has a sleeve: slide this sleeve in towards the machine and firmly push the small end of the solution hose into the connector. Release the sleeve to lock the hose into place.



Connect the other end of the solution hose to the brass fitting on the cleaning wand (1b).

TIP: Slide back the brass sleeve on the hose and firmly push the hose onto the connector on the wand. Release the sleeve to lock the hose into place.

- 2 Fill Tank B with 9 litres of hot tap water. The water should be level with the filter. Add Britex cleaning solution into Tank B, following the dosage instructions on the back of the bottle. No defoamer is required when using the low foaming Britex cleaning solutions.

While cleaning please endeavour not to allow Tank B to run dry. Top up as and when required.

- 3 Connect the large vacuum hose to the connection points on the dome lid of Tank A and onto the end of the cleaning wand. If the vacuum hose cuffs become loose, turn them anti-clockwise to tighten.

- 4 Plug the machine into your powerpoint. For carpet and upholstery cleaning push both the VAC and PUMP buttons. Refer over page for instructions on cleaning carpet, rugs and upholstery.

NOTE: The tap button at the rear of the machine should be used to empty clean water out of the machine after use.

IMPORTANT: Do not pick up the machine by tank B

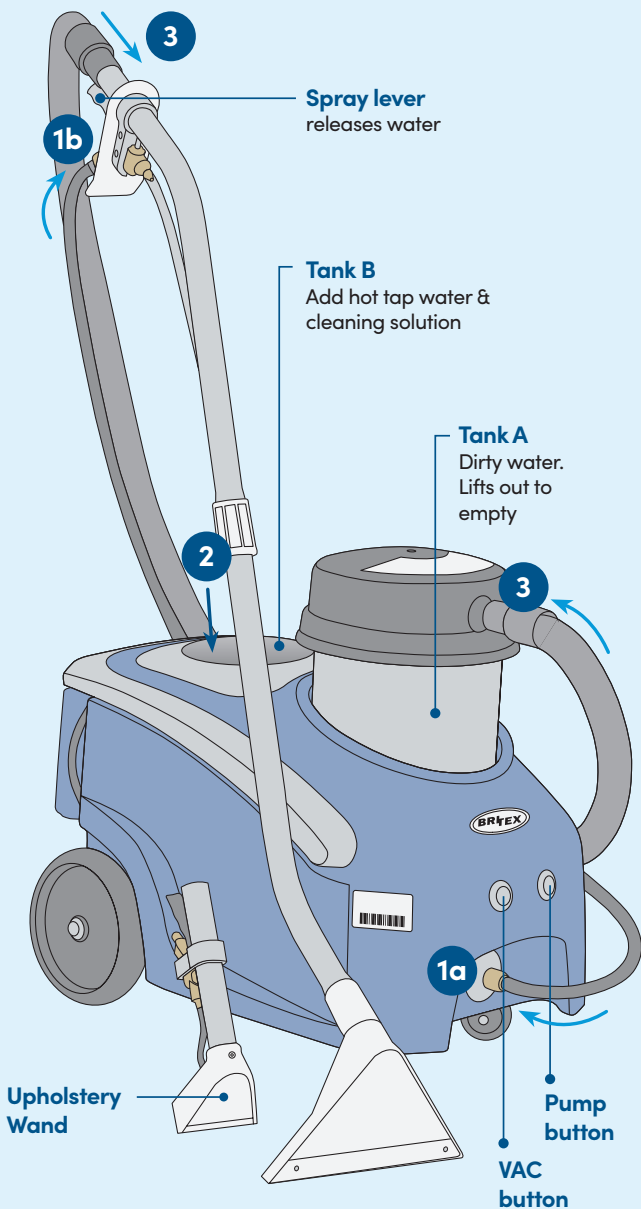

Need help?

Call **1800 804 973**
7 Days a Week

Pre-treat your stubborn stains and odours before deep cleaning!



Spot n Stain Remover removes common household stains from carpet and upholstery. Also great for cleaning barbecues!



Britex Urine Remover is a powerful, enzyme-based formula that removes urine and other pet stains from carpets and upholstery. No touching or scrubbing required.



Odour Blaster eliminates foul odours from carpet and upholstery, including mildew, smoke, pet accidents, sewage, vomit and perspiration.



Grout & Tile spray cleans grimy grout in kitchens and bathrooms!

How do I clean carpet and rugs?

TIP: Use the Britex carpet wand like you would a vacuum, moving the head forwards and backwards over the carpet.

- 1 Hold in the spray lever on the wand to apply water and solution to the carpet. To STOP spraying water, release the trigger on the wand. Then move the wand head over the dampened area to remove water and dirt, as if vacuuming your carpet.



IMPORTANT: Always check the care instructions for your carpet and rugs prior to deep cleaning. Always patch test in an inconspicuous area prior to commencing a full surface clean. Apply a light spray of water. Do not saturate the carpet. For every pass where you spray water, use 2-3 passes WITHOUT spraying to extract the water and dirt from the carpet and speed up the drying process.

- 2 Repeat this process over stained areas.
- 3 Periodically check Tank A and discard the dirty water. Dirty water can be discarded down the laundry sink.
- 4 Follow step 2 from 'how to set-up the machine' when adding more clean water and solution to Tank B.

How do I clean upholstery?

- 1 On the upholstery wand hold in the spray lever to release the water & solution around 10 cms above the fabric ensuring you do not oversaturate. To STOP spraying, release the trigger on the wand. Ensure the opening of the upholstery wand head is flat on the surface of the fabric. Move the wand head over the dampened area to extract the water.

IMPORTANT: Always check the care instructions for your upholstery prior to deep cleaning. Always patch test in an inconspicuous area prior to commencing a full surface clean. Apply a light spray of water. Do not saturate the upholstery. For every pass where you spray water, use 2-3 passes WITHOUT spraying to extract the water and dirt from the fabric and speed up the drying process.

- 2 Repeat this process over stained areas.
- 3 Periodically check Tank A and discard the dirty water. Dirty water can be discarded down the laundry sink.
- 4 Follow step 2 from 'how to set-up the machine' when adding more clean water and solution to Tank B.

How do I clean up flooded floors?

Turn on the VAC switch and use the carpet wand to extract water from the floor. Empty the dirty water from Tank A as needed. No cleaning solutions are required.

Troubleshooting

What to do if the Britex machine stops spraying?

You may have an airlock. To fix this, press the pump button on the machine on (keep the vac off). Lay the cleaning wand on the floor and squeeze the spray lever on the wand continuously for 3 minutes (keeping the wand on the floor). If this does not resolve the issue, please call us on 1800 804 973.

IMPORTANT: Before you return the Britex machine to the store, please remember to:

- Empty any water out of the clean water Tank B, using the tap on the back of the machine.
- Empty the dirty water Tank A, rinse it clean and wipe it dry. Rinse out the dome lid and filter.
- Wipe the exterior of the machine thoroughly.



If you spill any of the Britex cleaning solutions onto a benchtop, furniture or hard flooring, please wipe up the spill immediately to avoid staining.

Need help?

Call 1800 804 973

7 Days a Week

Mon - Fri (AEST) 9am-5pm
Sat - Sun (AEST) 10am-5pm
Public Holidays (AEST) 10am-5pm
Closed Good Friday, Christmas Day and Boxing Day

Where can I hire a Britex machine?

Scan the QR code to find your
nearest Britex hire outlet. Or visit
www.britex.com/store-locator



For cleaning instructions

Scan the QR code or go to
britex.com/support



Follow us on social media for cleaning tips & advice



BritexCarpetCare



BritexCarpetCareDIY



BritexCarpetCare



When you hire a Britex deep cleaning machine you
are supporting a proudly Australian owned business.



Britex Carpet Care

Unit 10, 25-37 Chapman St, Blackburn North, VIC 3130
P 1800 804 973 www.britex.com